

APPENDIX C

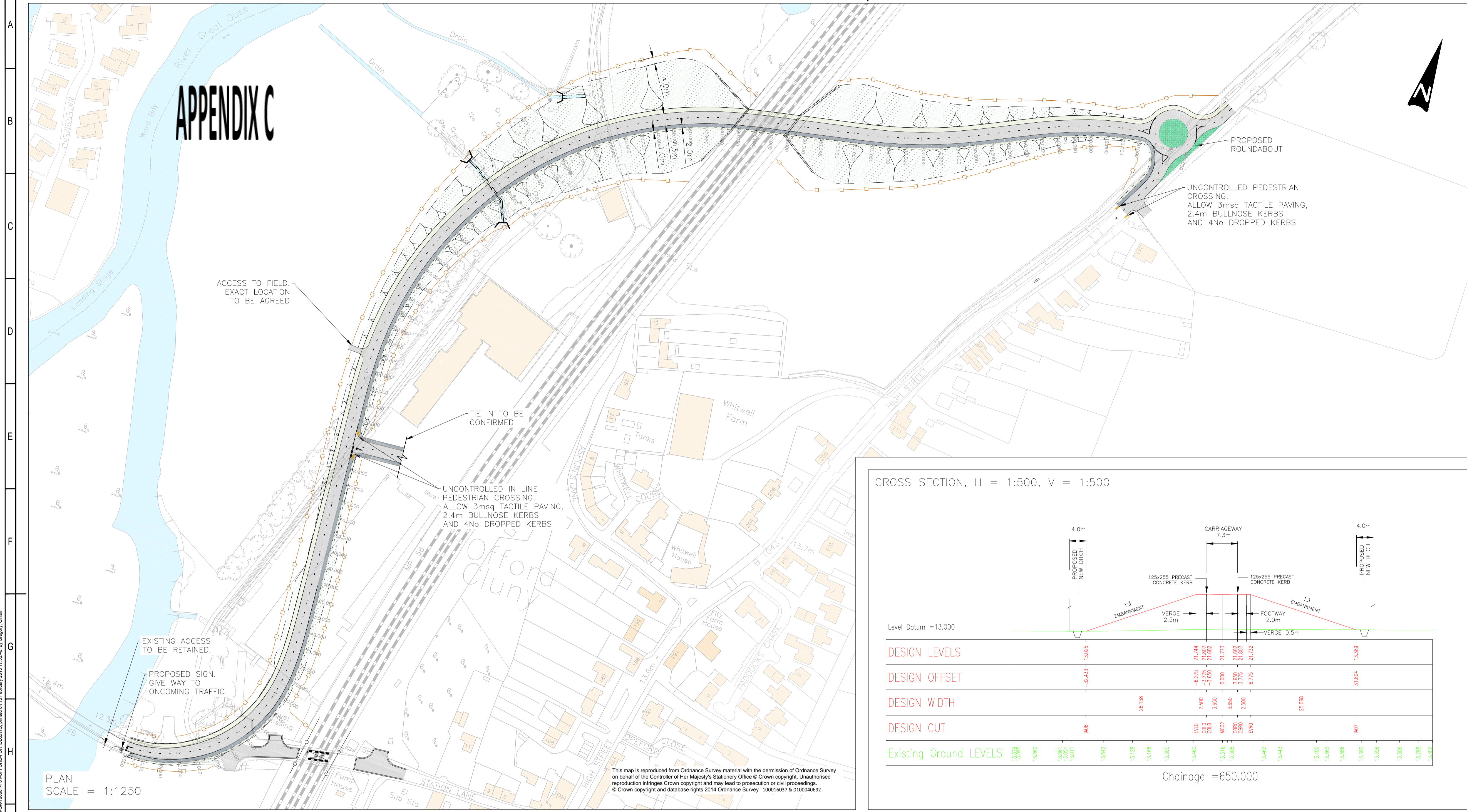

- DO NOT SCALE**
- KEY:
- EXISTING LEVEL CROSSING TO BE CLOSED
 - PROPOSED HIGHWAY DIVERSION. CARRIAGEWAY CONSTRUCTION CONSISTS OF THE FOLLOWING:
40MM THIN SURFACE COURSE SYSTEM
70MM DENSE BINDER COURSE AC/20
250MM DENSE BASE COURSE AC132
BASE 40/60 DES
270MM TYPE 1 GRANULAR SUB-BASE
200MM CAPPING LAYER
 - PROPOSED VERGE
 - PROPOSED FOOTWAY. CONSTRUCTION TO CONSIST OF THE FOLLOWING:
20MM THICK SURFACE COURSE AC6
DENSE 100/500 PEN
50MM BINDER COURSE AC20 DENSE BIN 40/60 DES
150MM GRANULAR SUB-BASE
 - PROPOSED TURNING HEAD TO HCD H5
 - PROPOSED TIE IN TO HCD H5
 - INSTALL NEW STEEL PALISADE FENCING & GATE 2M HIGH OR TO MATCH EXISTING. ALLOW FOR HIGH SECURITY CHAIN & BOLT/LOCK IN LOCATION OF NR ACCESS.
 - PROPOSED EARTHWORKS: ALLOW FOR 200MM TOP SOIL STRIP PRIOR TO EARTHWORKS OPERATIONS & 150MM TOP SOIL PLACE FOLLOWING COMPACTION OF EARTHWORKS.
 - PIPE EXISTING DITCH & CONSTRUCT NEW HEADWALL
 - PIPE EXISTING DITCH
 - RE-DIRECT DITCH
 - ABANDONED DITCH
 - UPGRADE EXISTING ACCESS TRACK WITH 50MM VEGETAL ASPHALT CONCRETE MIX OR SIMILAR APPROVED AND 250MM TYPE 1 SUB-BASE
 - PROPOSED NEW SIGN
 - PROPOSED NEW STRUCTURE
- NOTES:
- THE STATUTORY APPARATUS SHOWN ON THIS DRAWING, SHOWS THE APPROXIMATE LOCATION ONLY. TRIAL PITS ARE RECOMMENDED TO ASCERTAIN EXACT LOCATION OF SERVICES.
 - ALLOWANCE IS TO BE MADE FOR 4 X 150m (600m) VRS & FENCE SYSTEM EITHER SIDE OF THE PARAPETS.

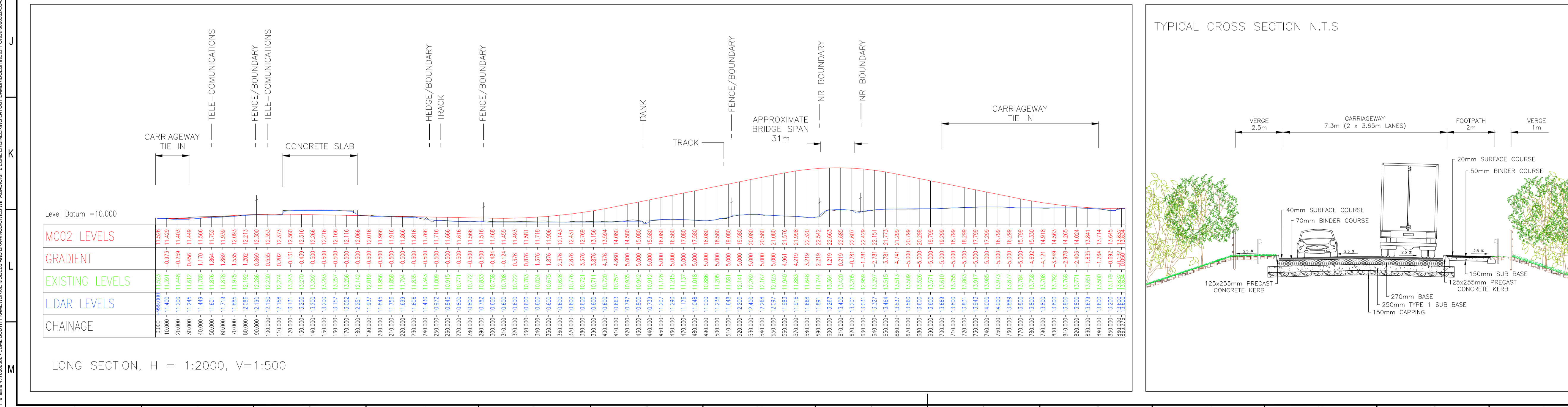
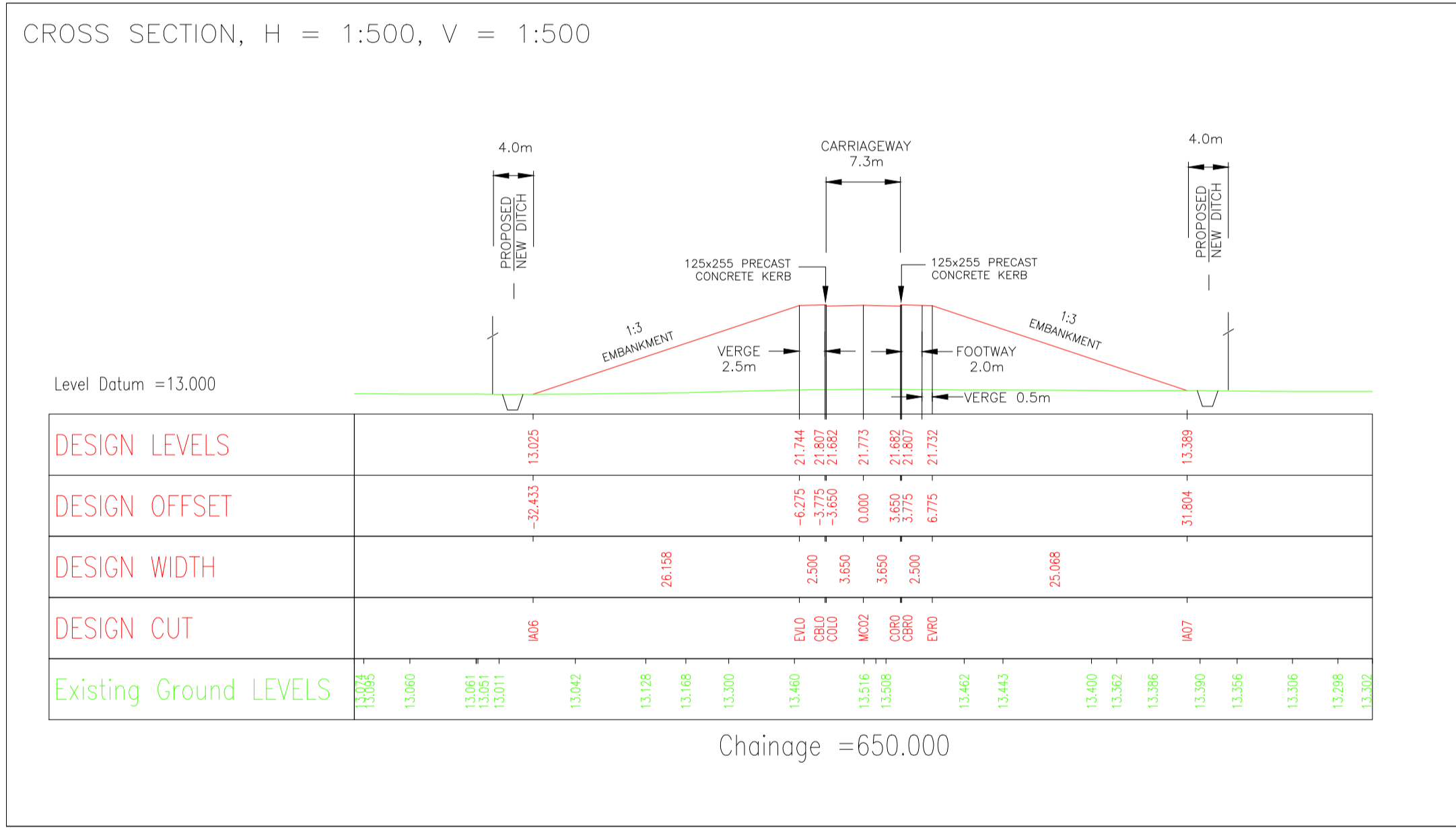

DRAFT WORK-IN-PROGRESS

| REV | DATE | BY | DESCRIPTION | CHK | APP |
|-----|------|----|-------------|-----|-----|
| | | | | | |

DRAWING STATUS: DRAFT

WSP
One Queens Drive, Birmingham, West Midlands, B5 4PJ
Tel: +44 (0)121 352 4700, Fax: +44 (0)121 352 4701
http://www.wspgroup.com

CLIENT: NetworkRail

PROJECT: ECML

TITLE: OFFORD - OPTION 2_REV B GENERAL ARRANGEMENT

| | | |
|---|-------------------------------|------------------|
| SCALE @ A1: AS SHOWN | CHECKED: G/MG | APPROVED: |
| CAD FILE: 7000382-LC-C05-GA-10001-P01-OFFORD-DR | DESIGN/DRAWN: LR/AB/DMC | DATE: 15/01/2015 |
| PROJECT No: 70000382 | DRAWING No: LC-PO5/GA/100/002 | REV: P01 |

© WSP Group plc